

Safety shut-off Valves - series VSC

Gas safety solenoid shut-off valve series VSC are manufactured in conformity to the Norm EN 161 and are suitable for the automatic control of gases belonging to the first, second and third family.

These valves, normally closed for continuous and cyclic operation, open by powering the coil and close quickly when there is no tension.



TECHNICAL FEATURES

Body valve	Aluminium
Connections	Rp 1/2
Max Inlet pressure	200 mbar and 1 bar
Opening/Closing Time	< 1 second
Standard supply voltage	230V ac
Frequency	50 ÷ 60 Hz
Enclosure	IP 65 - IEC 529
Duty cycle	Continuous 100%
Ambient temperature	-20 ÷ +60 °C

FEATURES

- Class A, Group 2 according to EN161
- Normally closed
- Quick opening and closing
- PA resin encapsulated coils
- Quiet operation

DIMENSIONS AND MODELS

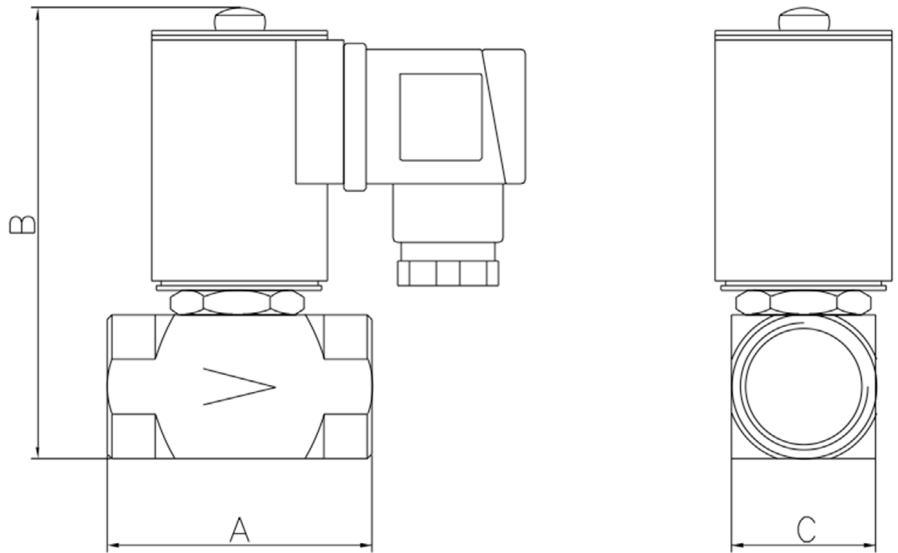

Connection	Max pressure in mbar	Rating at 230V "in VA"	Dimensions in mm			Weight Kg.	Code	
			A	B	C		With max. flow adjustment	Without max. flow adjustment
1/2"	200	9	55	90,50	37	0,6	VSCR215C	VSCR215C
1/2"	1000	18	50	100,30	30	0,5	VSCR1015C	VSCR1015C

FLOW DIAGRAM

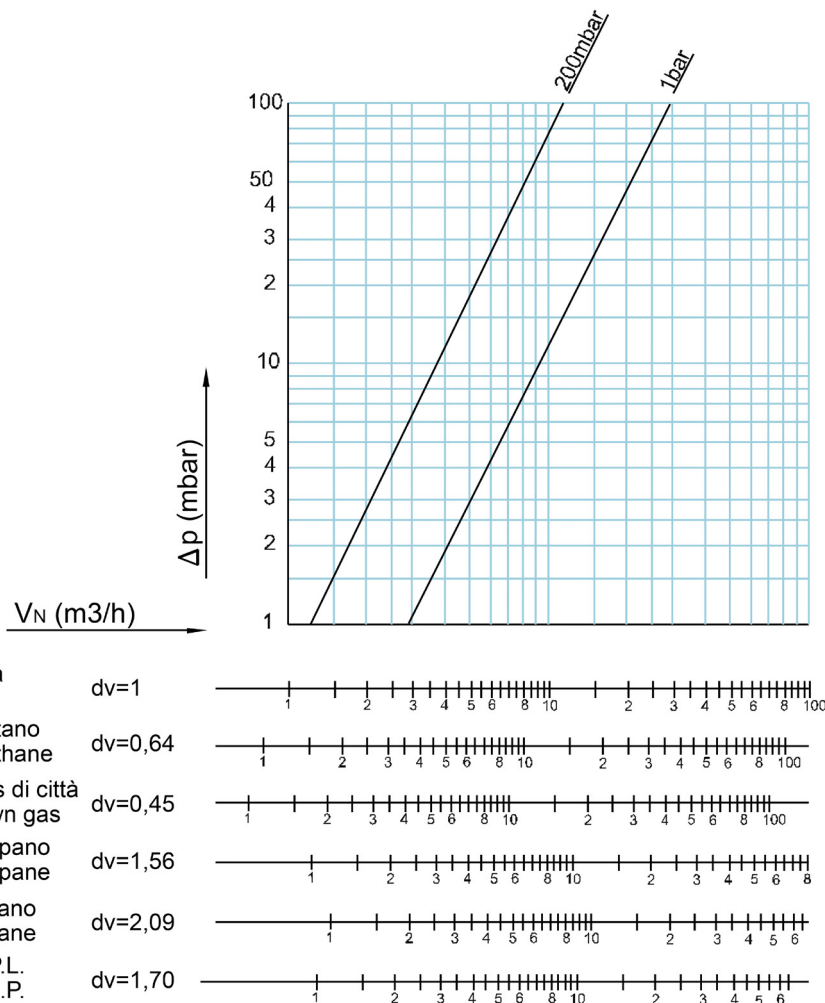

The data is subject to change without notice.

form 140303

econex

Econex s.r.l. - Via Francesco De Sanctis, 53 - I-20141 Milano
 Tel. +39 0289502912 - Fax +39 028463084 - www.econex.it - info@econex.it